

Ball Valve with Flange or Weld Ends

DN 25 - 300, ANSI Class 2500 / PN 420



Standard Materials:

Body:	TSTE 355N/P355 NL1; ASTM 350LF2; ASTM A106 and others
Ball:	ASTM A350LF2; ASTM A105; ASTM A395; ASTM A694 + ENP or hardchrome; stainl. steel and others
Seat rings:	ASTM 350LF2; ASTM A105 + ENP or hardchrome; stainless steel
O-Rings:	FPM; EPDM; NBR; HNBR
Seat Insert:	FPM; PTFE; PTFE-filled, HNBR

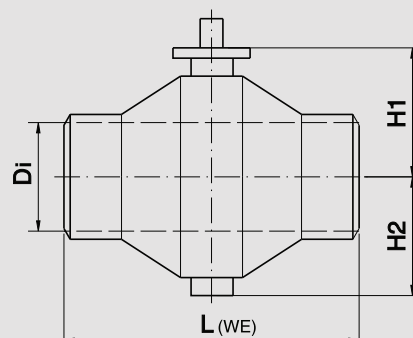
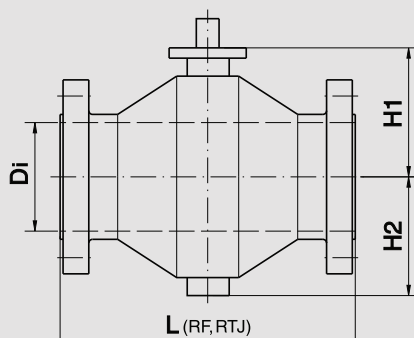

Nominal size		Diameter	Face to face dimensions					Weight	
DN		Di	L(RF)	L(RTJ)	L(WE)	H1	H2	Flange	Weld Ends
mm	inch	mm	mm	mm	mm	mm	mm	kg	kg
25	1	25	254	257	254			37	20
50	2	42	451	454	368	145	105	82	36
80	3	62	578	584	410	195	155	175	80
100	4	87	673	683	490	232	180	340	185
150	6	131	914	927	610	285	234	770	380
200	8	179	1022	1038	870	363	290	1250	720
250	10	223	1270	1292	995	415	345	2000	1050
300	12	265	1422	1445	1145	498	415	2700	1400



For deviating operating conditions please send us a written request stating the fluids, as well as the pressure and temperature range.

The materials which are mentioned in the table are the Böhmer standard materials. They comply with the most common national and international standards.

Other materials, which may be necessary due to special applications / conditions (such as corrosion / abrasion as well as temperature etc.) or customers' demands are deliverable on request.