

# Ball Valve with Flange or Weld Ends

**DN 25 - 250, ANSI Class 900 | PN 160\***



## Standard Materials:

<b>Body:</b>	TSTE 355N/P355 NL1; ASTM 350LF2; ASTM A106
<b>Ball:</b>	ASTM A350LF2; ASTM A105; ASTM A395; ASTM A694 + ENP or hardchrome; stainl. steel
<b>Seat rings:</b>	ASTM 350LF2; ASTM A105 + ENP or hardchrome; stainless steel
<b>O-Rings:</b>	FPM; EPDM; NBR; HNBR
<b>Seat Insert:</b>	FPM; PTFE; PTFE-filled, HNBR

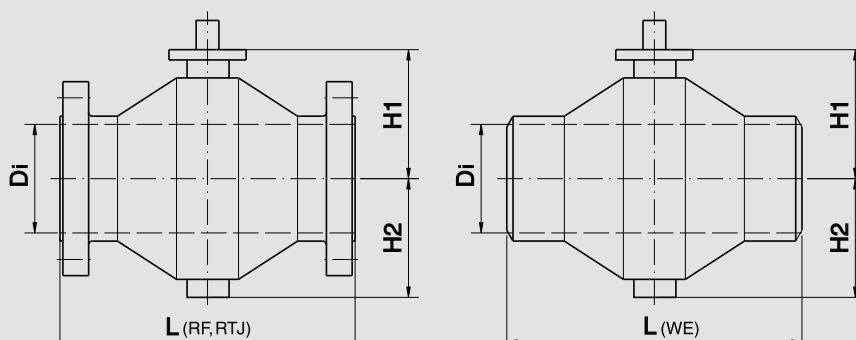

For deviating operating conditions please send us a written request stating the fluids, as well as the pressure and temperature range.

The materials which are mentioned in the table are the Böhmer standard materials. They comply with the most common national and international standards.

Other materials, which may be necessary due to special applications / conditions (such as corrosion / abrasion as well as temperature etc.) or customers' demands are deliverable on request.

Nominal size		Diameter	Face to face dimensions			Weight			
DN		Di	L(RF)	L(RTJ)	L(WE)	H1	H2	Flange	Weld Ends
mm	inch	mm	mm	mm	mm	mm	mm	kg	kg
25	1	25	216	216	216	55	29	7	3
50	2	51	368	372	292	78	61	23	10
80	3	78	381	384	356	160	116	49	32
100	4	102	457	460	432	192	135	83	56
150	6	152	610	613	559	228	178	185	115
200	8	203	737	740	660	295	224	395	230
250	10	254	838	841	787	343	275	620	405

\* DIN face-to-face dimensions are deliverable as well.

# Ball Valve with Flange or Weld Ends

**DN 300 - 1200, ANSI Class 900 | PN 160\***



## Standard Materials:

<b>Body:</b>	TSTE 355N/P355 NL1; ASTM 350LF2; ASTM A106 and others
<b>Ball:</b>	ASTM A350LF2; ASTM A105; ASTM A395; ASTM A694 + ENP or hardchrome; stainl. steel and others
<b>Seat rings:</b>	ASTM 350LF2; ASTM A105 + ENP or hardchrome; stainless steel
<b>O-Rings:</b>	FPM; EPDM; NBR; HNBR
<b>Seat Insert:</b>	FPM; PTFE; PTFE-filled, HNBR

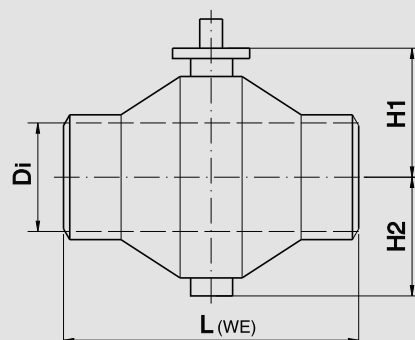
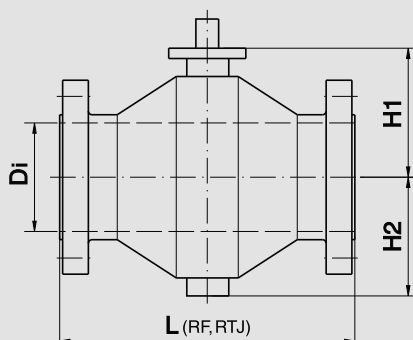

For deviating operating conditions please send us a written request stating the fluids, as well as the pressure and temperature range.

The materials which are mentioned in the table are the Böhmer standard materials. They comply with the most common national and international standards.

Other materials, which may be necessary due to special applications / conditions (such as corrosion / abrasion as well as temperature etc.) or customers' demands are deliverable on request.

Nominal size		Diameter	Face to face dimensions					Weight	
DN		Di	L(RF)	L(RTJ)	L(WE)	H1	H2	Flange	Weld Ends
mm	inch	mm	mm	mm	mm	mm	mm	kg	kg
300	12	305	965	968	838	413	330	920	670
350	14	324	1029	1038	889	461	373	1280	920
400	16	375	1130	1140	991	505	412,5	1620	1210
450	18	425	1219	1232	1030	563	471	2100	1650
500	20	473	1321	1334	1190	621,5	519	2680	2040
550	22	524	1422	1435	1130	671	566	3420	2750
600	24	572	1549	1568	1295	708	615	4290	3320
700	28	667	1549	1562	1359	772	685	6100	4950
750	30	714	1651	1664	1422	820	740	7800	6500
800	32	762	1778	1794	1486	887	805	9750	7800
900	36	857	2083	2099	1625	945	865	13900	10400
1000	40	956	2225	2254	2010	1120	995	17800	14700
1050	42	1006	2285	2314	2085	1187	1055	19600	16300
1200	48	1149	2460	2489	2210	1380	1215	28500	24500

\* DIN face-to-face dimensions are deliverable as well.