

Ball Valve with Weld Ends

BBF/KSF-V-HS, DN 10-200, PN 25

Full Bore



Standard Materials:

Body:	Forged Steel / Steel
Ball:	Stainless Steel
Stem:	Stainless Steel
Ball seals:	PTFE
Stem seals:	EPDM

Operating Temperature: up to +150 °C

Design features:

- From DN125 the trunnion mounted ball is standard.
- From DN150 operation with a gear box is recommended.
Please use the products described on page 29.

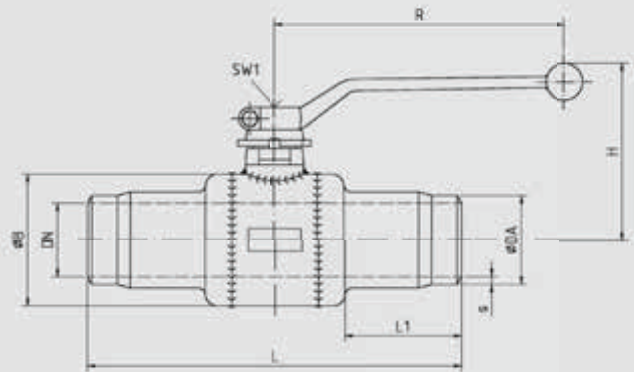

DN	PN	DA	s	L	L1	B	H	R	SW1	Weight	Item No.
mm	bar	mm	mm	mm	mm	mm	mm	mm	mm	kg	
10	25	17,2	2,3	270	102	39	66	130	10	0,9	010.6807
15	25	21,3	2,6	270	97	39	68	130	10	1,0	010.3233
20	25	26,9	3,2	270	97	44	70	130	10	1,3	010.2936
25	25	33,7	3,2	270	90	54	82	180	12	1,7	010.2955
32	25	42,4	3,2	270	95	64	110	205	16	2,6	010.3309
40	25	48,3	3,2	270	90	76	115	205	16	3,3	010.3431
50	25	60,3	3,6	250	80	89	125	205	16	4,6	010.7353
65	25	76,1	3,6	270	80	121	140	300	16	8,3	010.8514
80	25	88,9	4,0	280	78	140	160	350	22	11,5	010.3187
100	25	114,3	4,0	300	79	171	175	350	22	16,2	010.3188
125	25	139,7	4,5	350	90	203	195	500	22	27,0	010.3381
150	25	168,3	5,0	400	90	254	240	600	32	51,0	010.3348
200	25	219,1	6,3	460	96	324	275	600	32	82,5	010.2762



For deviating operating conditions please send us a written request stating the fluids, as well as the pressure and temperature range.

Further options for these ball valves are listed on page 48.

Ball Valve with Weld Ends

BBF/KSF-V-HS, DN 150-1200, PN 25



Standard Materials:

Body:	Forged Steel / Steel
Ball:	up to DN 400: Stainless Steel from DN 450: Steel, chemically nickel plated (ENP)
Stem:	Stainless Steel
Ball seals:	PTFE
Stem seals:	EPDM

Operating Temperature: up to +150 °C

Full Bore

Design features:

- The trunnion mounted ball is standard.
- From DN150 we recommend the use of worm gears (or planetary gear units up to max. DN400).
On request the ball valves can be delivered with electric or pneumatic actuators.
- For the valves listed below, the worm gear unit is included in the delivery.

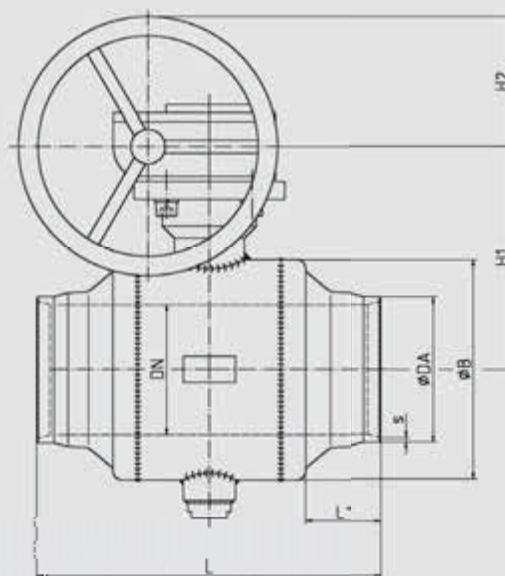

For deviating operating conditions please send us a written request stating the fluids, as well as the pressure and temperature range.

Further options for these ball valves are listed on page 48.

DN	PN	Da	s	L	L1	B	H1	H2	Weight	Item No.
mm	bar	mm	mm	mm	mm	mm	mm	mm	kg	
150	25	168,3	5,0	400	90	254	349	150	90	075.0267
200	25	219,1	6,3	460	96	324	384	150	136	075.0268
250	25	273,0	7,1	540	90	407	355	200	290	075.0269
300	25	323,9	8,0	640	91	508	404	200	458	075.0270
350	25	355,6	8,0	680	86	559	431	200	608	075.0271
400	25	406,4	8,8	1000	319	660	490	250	770	075.0272
450	25	457,0	6,3	950	158	720	567	200	ca. 1300	on request
500	25	508,0	6,3	991	136	814	608	250	ca. 1800	on request
600	25	610,0	7,1	1143	158	955	737	300	ca. 2500	on request
700	25	711,0	8,0	1295	187	1116	870	300	ca. 4000	on request
800	25	813,0	8,8	1397	430	1261	942	400	ca. 4900	on request
900	25	914,0	10,0	1499	422	1396	1051	400	ca. 7000	on request
1000	25	1016,0	11,0	1800	576	1561	1180	400	ca. 9900	on request
1200	25	1220,0	12,5	2800	955	1890	1512	500	ca. 18500	on request

Ball valves DN500 and above will be custom designed to meet order specifications.
Please take note of the drawings submitted in case of an order.