

Gate Valves

Type 09420



Flanged Gate Valves, PN16, DIN EN 12288

Bronze body, screwed topwork in brass with maintenance-free gland packing (O-Ring) and non rising stem flanged connection acc. to DIN EN 1092-3 PN16

Part No. 09420.X.000000

· Standard valve

Part No. 09420.X.010000

· Valve with locking device without lock

Part No. 09420.X.020000

· Valve with locking device with lock

option:
Locking device →



Applications:

Suitable for transformer oil.

Working temperatures: -25°C / -13°F (248K) up to +120°C / +248°F (393K) and maximum 6.0 bar

Materials	DIN EN	ASTM
1 Body	CC491K	B 62 UNS C83600
2 Wedge	CC491K	B 62 UNS C83600
3 Stem	CW614N	B 283 UNS C38500
4 Bonnet gasket	Klingsil C-4400	
5 Headpiece	CW614N	B 283 UNS C38500
6 O-Rings	FPM (Viton)	
7 Handwheel	Aluminium - diecasting	

Essential: When ordering or requesting an offer please indicate flow medium, working pressure and working temperature.

Standard marking acc. to Pressure Equipment Directive 2014/68/EU (PED).

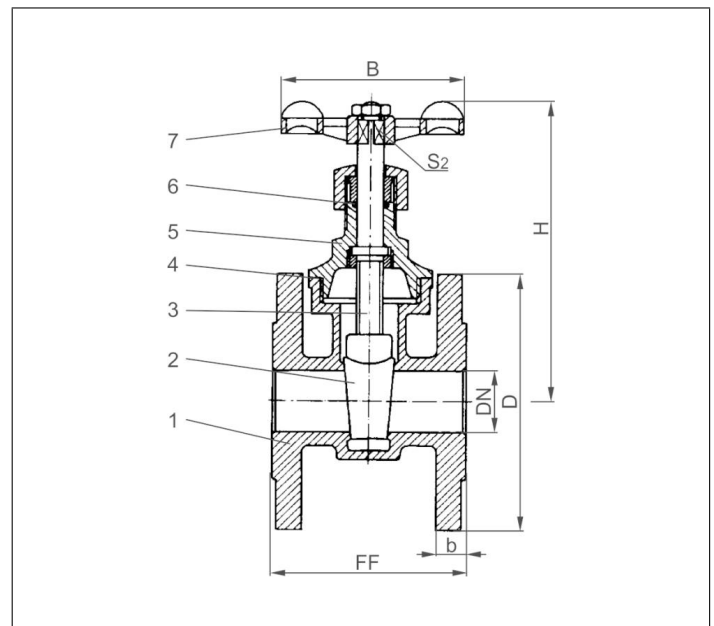

Type 09420	Technical data							
Nominal size	DN	25	32	40	50	65	80	100
Dimension code	.X.	0250	0320	0400	0500	0650	0800	1000
Face-to-face dimension	FF	80	90	100	110	130	150	165
Height	H	120	135	155	180	225	250	295
Flange diameter	D	115	140	150	165	185	200	220
Width of flange	b	12	14	14	16	16	18	20
Handwheel-Ø	B	70	80	80	110	130	150	150
Wrench size across flats	S ₂	8	9	9	11	12	14	14
Weight	approx. kg	2.5	3.9	4.9	7.0	9.5	12.1	19.0

Dimensions in mm.

Gate Valves

Type 09420



Flanged Gate Valves, PN16, DIN EN 12288

Bronze body, screwed topwork in brass with maintenance-free gland packing (O-Ring) and non rising stem flanged connection acc. to DIN EN 1092-3 PN16

Part No. 09420.X.100200

· Valve -50°C with opening indicator

Part No. 09420.X.110200

· Valve -50°C with opening indicator and locking device without lock

Part No. 09420.X.120200

· Valve -50°C with opening indicator and locking device with lock

option:
Locking device →

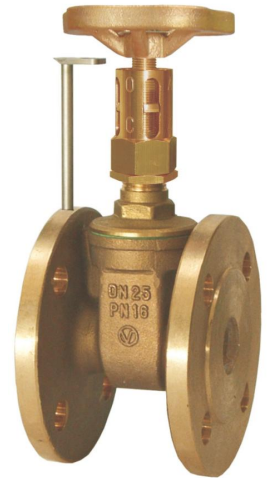

Applications:

Suitable for transformer oil.

Working temperatures: -50°C / -58°F (223K) up to +120°C / +248°F (393K) and maximum 6.0 bar

Materials	DIN EN	ASTM
1 Body	CC491K	B 62 UNS C83600
2 Wedge	CC491K	B 62 UNS C83600
3 Stem	CW614N	B 283 UNS C38500
4 Bonnet gasket	Klingsil C-4400	
5 Headpiece	CW614N	B 283 UNS C38500
6 O-Rings	Fluor - Silicon	
7 Handwheel	CC491K	B 62 UNS C83600

Essential: When ordering or requesting an offer please indicate flow medium, working pressure and working temperature.

Standard marking acc. to Pressure Equipment Directive 2014/68/EU (PED).

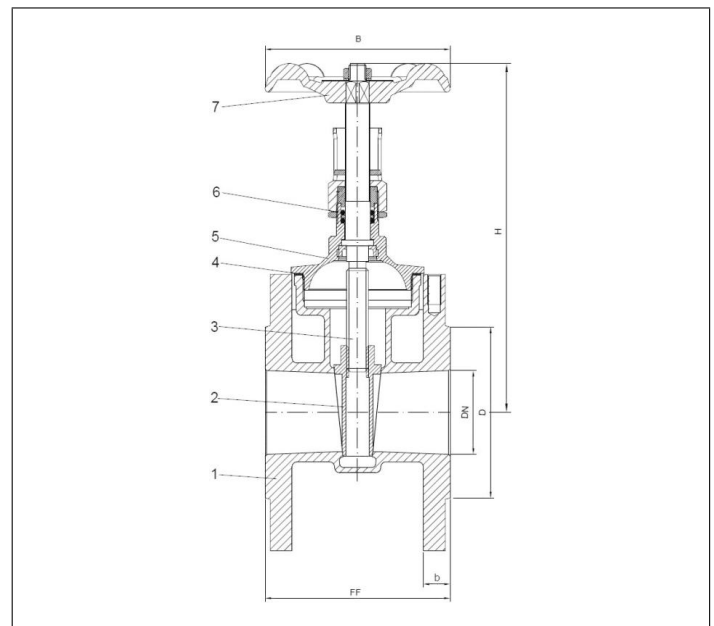

Type 09420	Technical data							
Nominal size	DN	25	32	40	50	65	80	100
Dimension code	.X.	0250	0320	0400	0500	0650	0800	1000
Face-to-face dimension	FF	80	90	100	110	130	150	165
Height	H	145	160	175	220	260	280	320
Flange diameter	D	115	140	150	165	185	200	220
Width of flange	b	12	14	14	16	16	18	20
Handwheel-Ø	B	80	100	100	125	140	150	150
Wrench size across flats	S ₂	8	9	9	11	12	14	14
Weight	approx. kg	2.6	4.0	4.9	6.8	8.0	12.2	19.0

Dimensions in mm.

Gate Valves

Type 09420



Flanged Gate Valves, PN16, DIN EN 12288

Bronze body, screwed topwork in brass
with maintenance-free gland packing (O-Ring) and non rising stem
flanged connection acc. to DIN EN 1092-3 PN16

Part No. 09420.X.000200

· Standard valve -50°C

Part No. 09420.X.010200

· Valve -50°C with locking device without lock

Part No. 09420.X.020200

· Valve -50°C with locking device with lock

option:
Locking device →

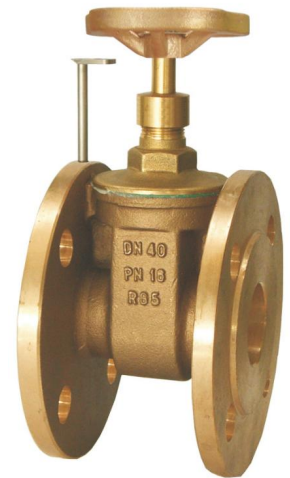

Applications:

Suitable for transformer oil.

Working temperatures: -50°C / -58°F (223K) up to +120°C / +248°F (393K) and maximum 6.0 bar

Materials	DIN EN	ASTM
1 Body	CC491K	B 62 UNS C83600
2 Wedge	CC491K	B 62 UNS C83600
3 Stem	CW614N	B 283 UNS C38500
4 Bonnet gasket	Klingsil C-4400	
5 Headpiece	CW614N	B 283 UNS C38500
6 O-Rings	Fluor - Silicon	
7 Handwheel	CC491K	B 62 UNS C83600

Essential: When ordering or requesting an offer please indicate flow medium, working pressure and working temperature.

Standard marking acc. to Pressure Equipment Directive 2014/68/EU (PED).

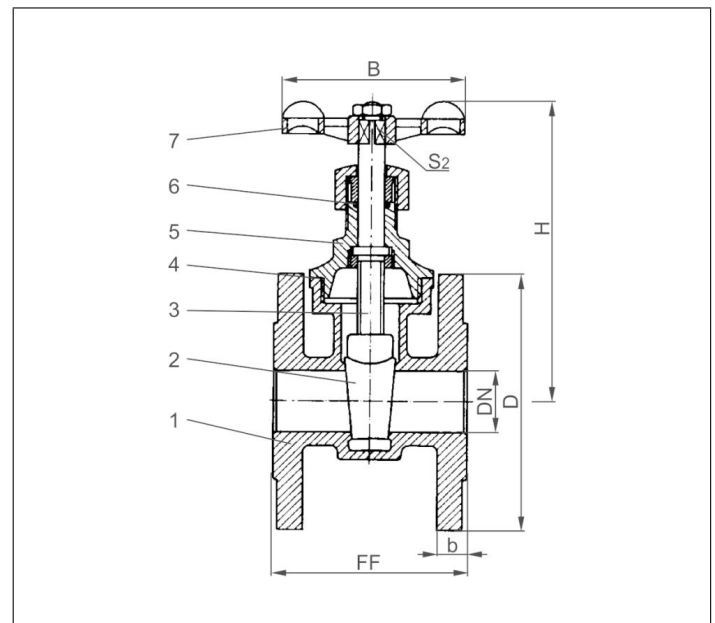

Type 09420	Technical data							
Nominal size	DN	25	32	40	50	65	80	100
Dimension code	.X.	0250	0320	0400	0500	0650	0800	1000
Face-to-face dimension	FF	80	90	100	110	130	150	165
Height	H	120	135	160	190	230	250	295
Flange diameter	D	115	140	150	165	185	200	220
Width of flange	b	12	14	14	16	16	18	20
Handwheel-Ø	B	80	100	100	125	140	150	150
Wrench size across flats	S ₂	8	9	9	11	12	14	14
Weight	approx. kg	2.5	3.9	4.9	7.0	9.5	12.1	19.0

Dimensions in mm.

Gate Valves

Type 09420



Flanged Gate Valves, PN16, DIN EN 12288

Body and screwed topwork in seawater resistant bronze with maintenance-free gland packing (O-Ring) and non rising stem
flanged connection acc. to DIN EN 1092-3 PN16

Part No. 09420.X.100226

· Valve -50°C with opening indicator

Part No. 09420.X.110226

· Valve -50°C with opening indicator and locking device without lock

Part No. 09420.X.120226

· Valve -50°C with opening indicator and locking device with lock

option:
Locking device →

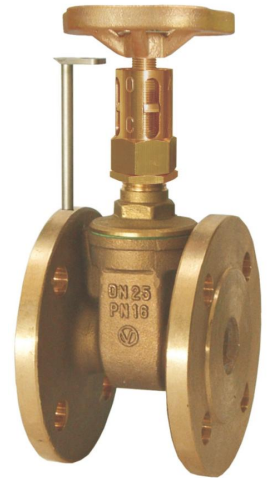

Applications:

Suitable for transformer oil.

Working temperatures: -50°C / -58°F (223K) up to +120°C / +248°F (393K) and maximum 6.0 bar

Materials	DIN EN	ASTM
1 Body	CC480K	B 30 UNS C90700
2 Wedge	CC480K	B 30 UNS C90700
3 Stem	CC483K	B 30 UNS C90800
4 Bonnet gasket	Klingsil C-4400	
5 Headpiece	CC480K	B 30 UNS C90700
6 O-Rings	Fluorosilicone	
7 Handwheel	CC491K	B 62 UNS C83600

Essential: When ordering or requesting an offer please indicate flow medium, working pressure and working temperature.

Standard marking acc. to Pressure Equipment Directive 2014/68/EU (PED).

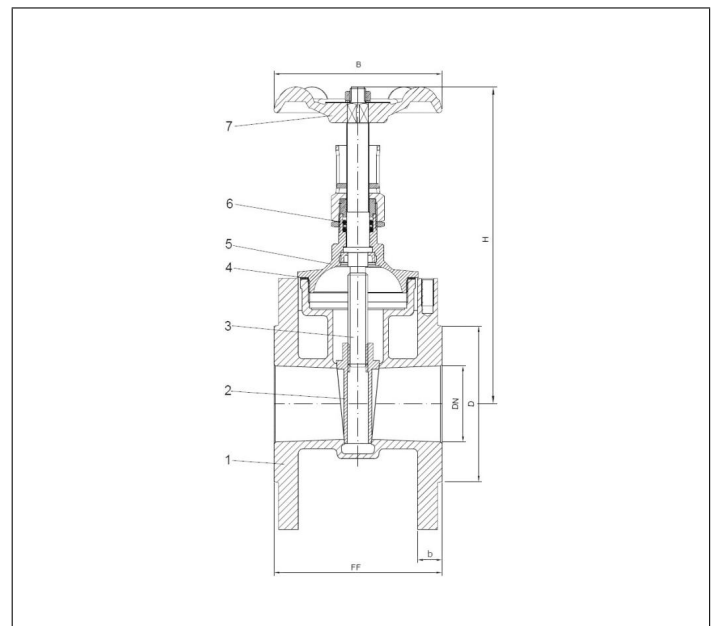

Type 09420	Technical data							
Nominal size	DN	25	32	40	50	65	80	100
Dimension code	.X.	0250	0320	0400	0500	0650	0800	1000
Face-to-face dimension	FF	80	90	100	110	130	150	165
Height	H	145	160	175	220	260	280	320
Flange diameter	D	115	140	150	165	185	200	220
Width of flange	b	12	14	14	16	16	18	20
Handwheel-Ø	B	80	100	100	125	140	150	150
Wrench size across flats	S ₂	8	9	9	11	12	14	14
Weight	approx. kg	2.6	4.0	4.9	6.8	8.0	12.2	19.0

Dimensions in mm.

Gate Valves

Type 09420



Flanged Gate Valves, PN16, DIN EN 12288

Body and screwed topwork in seawater resistant bronze with maintenance-free gland packing (O-Ring) and non rising stem flanged connection acc. to DIN EN 1092-3 PN16

Part No. 09420.X.000226

· Standard valve -50°C

Part No. 09420.X.010226

· Valve -50°C with locking device without lock

Part No. 09420.X.020226

· Valve -50°C with locking device with lock

option:
Locking device →

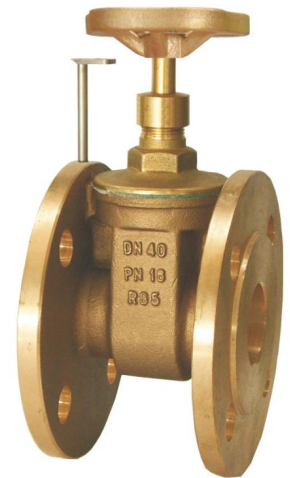

Applications:

Suitable for transformer oil.

Working temperatures: -50°C / -58°F (223K) up to +120°C / +248°F (393K) and maximum 6.0 bar

Materials	DIN EN	ASTM
1 Body	CC480K	B 30 UNS C90700
2 Wedge	CC480K	B 30 UNS C90700
3 Stem	CC483K	B 30 UNS C90800
4 Bonnet gasket	Klingsil C-4400	
5 Headpiece	CC480K	B 30 UNS C90700
6 O-Rings	Fluorosilicone	
7 Handwheel	CC491K	B 62 UNS C83600

Essential: When ordering or requesting an offer please indicate flow medium, working pressure and working temperature.

Standard marking acc. to Pressure Equipment Directive 2014/68/EU (PED).

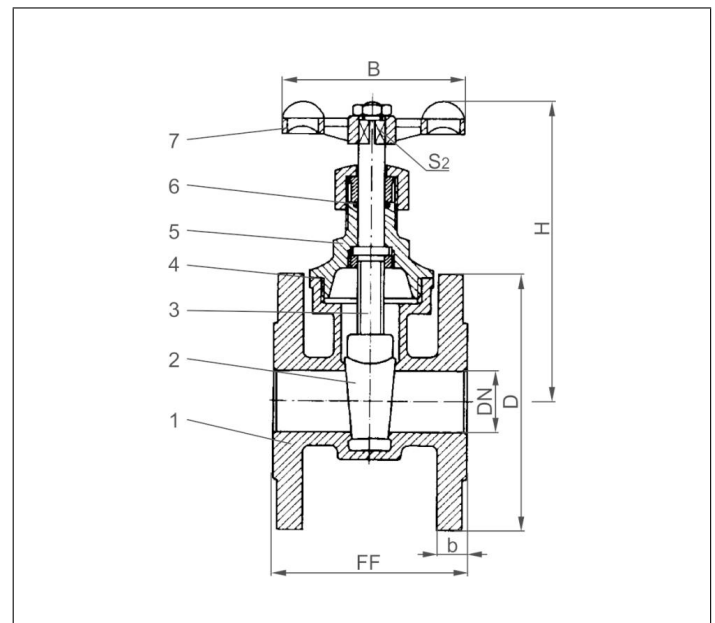

Type 09420	Technical data							
Nominal size	DN	25	32	40	50	65	80	100
Dimension code	.X.	0250	0320	0400	0500	0650	0800	1000
Face-to-face dimension	FF	80	90	100	110	130	150	165
Height	H	120	135	160	190	230	250	295
Flange diameter	D	115	140	150	165	185	200	220
Width of flange	b	12	14	14	16	16	18	20
Handwheel-Ø	B	80	100	100	125	140	150	150
Wrench size across flats	S ₂	8	9	9	11	12	14	14
Weight	approx. kg	2.5	3.9	4.9	7.0	9.5	12.1	19.0

Dimensions in mm.

Gate Valves

Type 09420



Flanged Gate Valves, PN16, DIN EN 12288

Bronze body, screwed topwork in brass with maintenance-free gland packing (O-Ring) and non rising stem flanged connection acc. to DIN EN 1092-3 PN16

Part No. 09420.X.100000

· Valve with opening indicator

Part No. 09420.X.110000

· Valve with opening indicator and locking device without lock

Part No. 09420.X.120000

· Valve with opening indicator and locking device with lock

option:
Locking device →

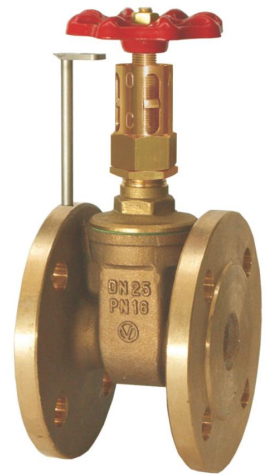

Applications:

Suitable for transformer oil.

Working temperatures: -25°C / -13°F (248K) up to +120°C / +248°F (393K) and maximum 6.0 bar

Materials	DIN EN	ASTM
1 Body	CC491K	B 62 UNS C83600
2 Wedge	CC491K	B 62 UNS C83600
3 Stem	CW614N	B 283 UNS C38500
4 Bonnet gasket	Klingsil C-4400	
5 Headpiece	CW614N	B 283 UNS C38500
6 O-Rings	FPM (Viton)	
7 Handwheel	Aluminium - diecasting	

Essential: When ordering or requesting an offer please indicate flow medium, working pressure and working temperature.

Standard marking acc. to Pressure Equipment Directive 2014/68/EU (PED).

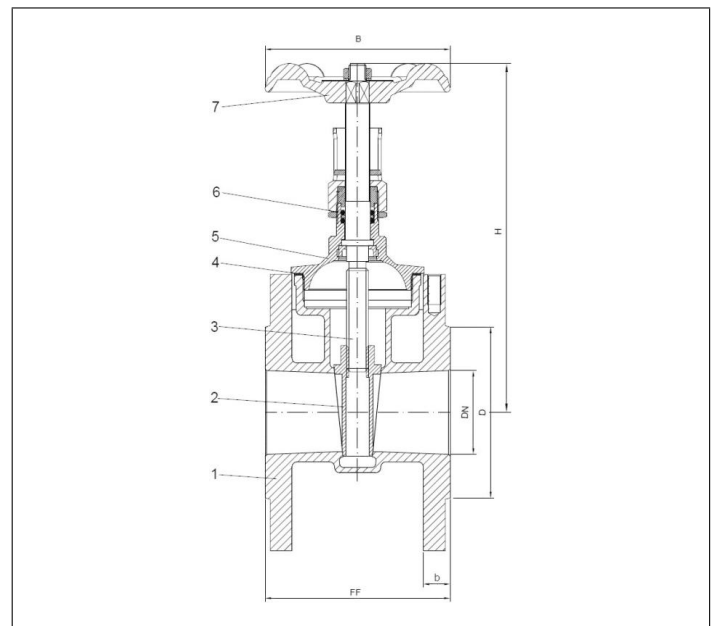

Type 09420	Technical data							
Nominal size	DN	25	32	40	50	65	80	100
Dimension code	.X.	0250	0320	0400	0500	0650	0800	1000
Face-to-face dimension	FF	80	90	100	110	130	150	165
Height	H	140	150	170	210	255	280	320
Flange diameter	D	115	140	150	165	185	200	220
Width of flange	b	12	14	14	16	16	18	20
Handwheel-Ø	B	70	80	80	110	130	150	150
Wrench size across flats	S ₂	8	9	9	11	12	14	14
Weight	approx. kg	2.6	4.0	4.9	6.8	8.0	12.2	19.0

Dimensions in mm.