

LARSLAP MODEL G

## Unique flexibility to grind both gate and globe valves.

A large range, portable machine ideal for gate, parallel slide, globe, check, safety and control valves, discs and wedges.

- Suitable for valves with flat seats  $\varnothing$  150–1300 mm (6"–52")
- Individually driven grinding heads for an absolute flat sealing surface
- The driving heads have diametrically adjustable grinding heads
- Tilting driving head gives flexibility to grind both gate and globe valves with the same drive unit
- Air drive unit as standard 6–7 bar
- Electric drive unit available as alternative
- Variable grinding speed on all drive units
- Self-adhesive grinding discs for quick attachment to the grinding heads
- Supplied with rough, medium and fine grinding discs
- Heavy duty carrying/storage case for the complete machine with all the necessary accessories
- Self-adhesive grinding discs 40 to 1000 grit available
- Diamond grinding discs available
- Adaptor plates for wider seats available
- Thin section driving heads available
- Grinding heads for angled seats available

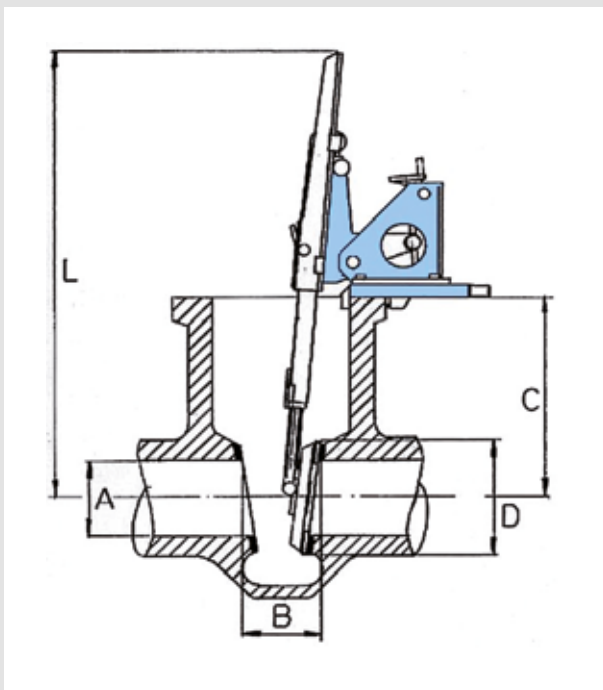

### Model G

A:	<b>140–1361 mm (6"–54,4")</b>
B:	<b>68 mm (2,72") min</b>
C:	<b>100 mm (4") min</b> <b>900 mm (36") standard</b> <b>1500 mm (60") max (option)</b>
D:	<b>150–1371 mm (6"–54,8")</b>
L:	<b>730 mm (29,2") min</b>
Carrying case:	<b>380 x 520 x 960 mm</b> <b>15,2" x 20,8" x 38,4"</b>
Total weight:	<b>67 kg (148 lb)</b>



*The LarsLap model G can do both gate and globe valves due to the unique flexibility of the driving unit.*

Tools with the cutting edge

# LarsLap Model G

Suitable for gate, check, safety,  
control valves and gate valve  
wedges

**Range: 150-1300mm (6"-52")**

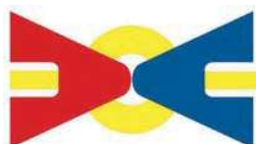
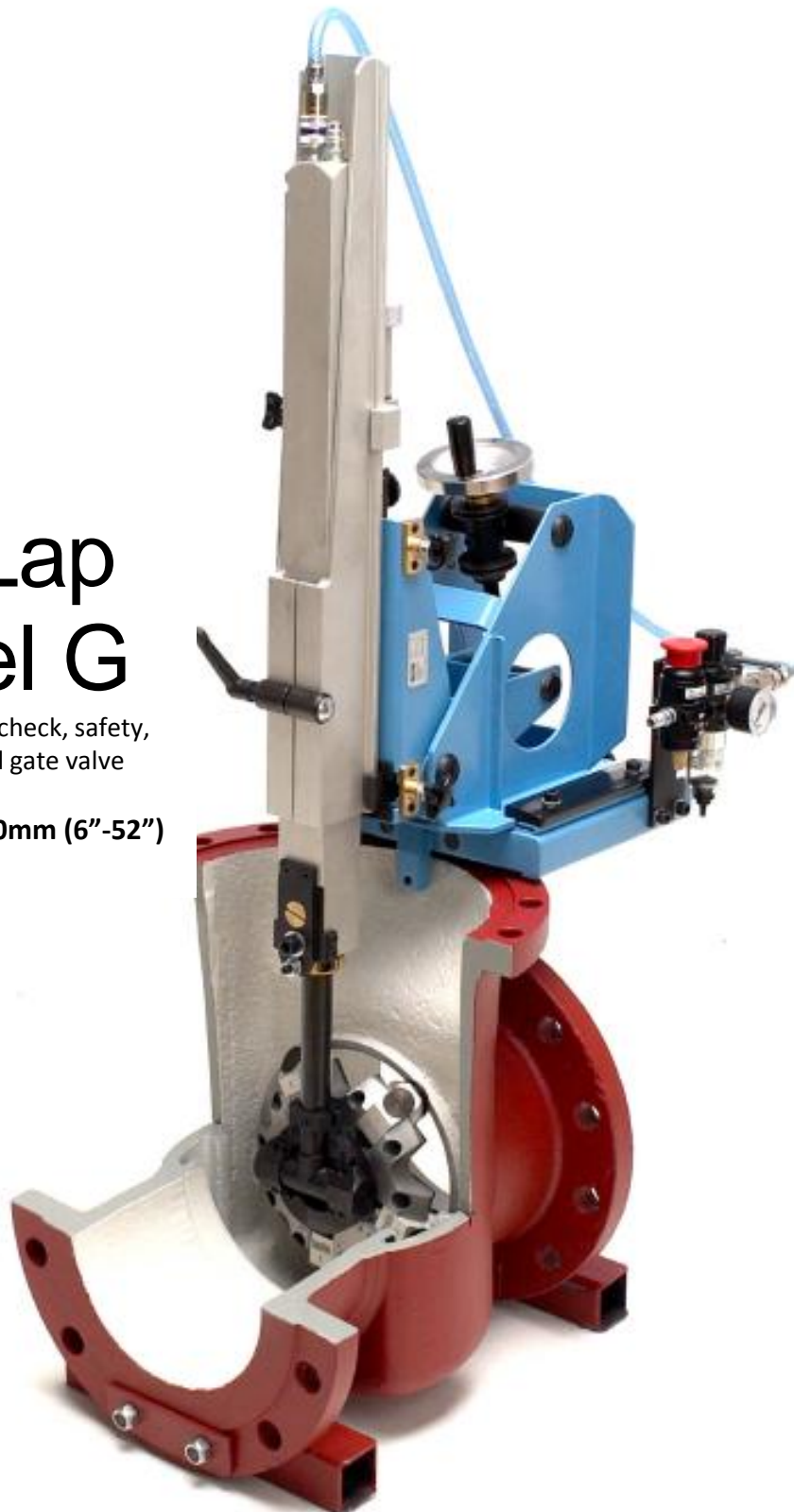

Justin goraad s.p.  
**atis**  
www.armature.si

**LarsLap**<sup>®</sup>

# Tools with the cutting edge

## LarsLap . the optimal grinding system



**Repairing leaking valves** in industrial pipelines is a laborious operation involving extended downtime, production losses and substantial, unwanted costs.

**Losses are minimized** if valves can be reground *in situ*, precluding the need to dismantle and remove defective valves from the pipeline.

**LarsLap's portable**, industrial valve grinders with their patented design concept are the proven solution for on-line valve reconditioning.

**Available in overlapping sizes**, LarsLap grinders combine unsurpassed versatility with exceptional ease of handling and operation.

**A combination guaranteed** to give LarsLap grinders cutting edge performance, whatever the valve location.



Welcome to the world of LarsLap

### LarsLap model G

The best way to a perfect result

#### On-line grinding for fast results

LarsLap model G's unique, lightweight universal clamping system allows rapid, accurate mounting for grinding valve seats or wedges.

Operating checks and replacement of abrasive discs can be carried out without disturbing the assembly. No realignment is necessary when repositioning the grinding head.



# Tools with the cutting edge

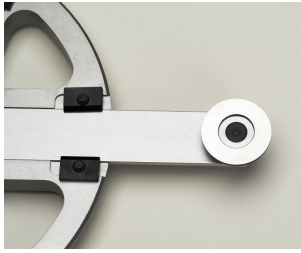

## Individually driven grinding heads for perfect results

Drive heads on LarsLap model G incorporate individually driven discs, permitting rapid and efficient grinding of exceptionally smooth, flat surfaces for tightest possible seats.



## Versatile and adjustable

The Model G drive head carries five telescopically adjustable radial arm to which the grinding heads are attached.

Grinding heads are available in a range of lengths and sizes, permitting numerous combinations within the 15061300 mm range (60652ö).

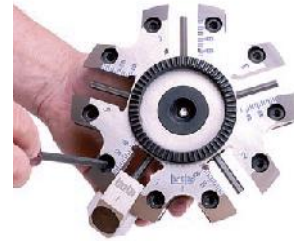

## Horizontal or vertical grinding

Model G drive heads can be angled to grind valve seats in any angle from vertical to horizontal.

## Wedges

The model G valve grinder is easily set up for wedge grinding using the existing clamping system.

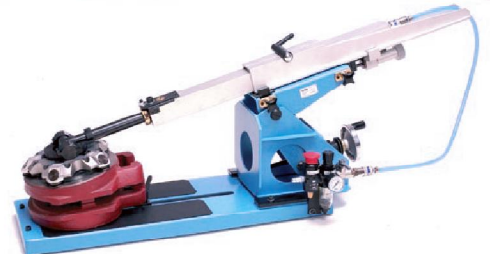

## Complete with carrying case

Every LarsLap model G is supplied with a rugged, customized carrying/storage case complete with all necessary accessories. The case is fitted with specially designed compartments molded to the shape of each component, allowing operators to confirm at glance that all items are in place before and after grinding.

## Unique flexibility

All LarsLap grinders are designed for operational compatibility. They can be run from bench-mountings and driven by pneumatic or electric powered motors. Equipment purchased initially for relatively small diameter ranges can be conveniently upgraded to deal with larger ranges at a later date.

This unique degree of flexibility means that grinders can be readily adapted to suit a wide variety of customer needs.



## LarsLap Grinding paper

Get the most out of your machine by using LarsLap original grinding paper. LarsLap grinding paper is tested, proved and perfectly fitted to suit your machine under the conditions it will be working in. (from 24 grit to 3mic)

## LarsLap model G

A selection of standard models  
Other configurations and accessories are available on request

	<b>G 300</b> 150- 300mm (6"-12")	<b>G 600</b> 150- 600mm (62-24")	<b>G 800</b> 150- 800mm (6"-32")	<b>G 1000</b> 150- 1000mm (6"-40")	<b>G 1300</b> 150- 1300mm (6"-52")	<b>G 300- 1300</b> 300- 1300mm (12"-52")
--	---	---	---	---	---	---

Base unit	.	.	.	.	.	.
Bottom plate for grinding gate valve wedges	.	.	.	.	.	.
Pneumatic drive unit (6-7 bar)	option	option	option	option	option	option
Regulator for pneumatic drive unit	option	option	option	option	option	option
Electric drive unit 110 or 220V	option	option	option	option	option	option
Holder for drive unit. Maximum depth 900mm (C-measure)	.	.	.	.	.	.
Extra long holder for drive unit. Maximum depth 1500mm (C-measure)	option	option	option	.	.	.
Driving head G I	.	.	.	.	.	option
Driving head G II	option	.	.	.	.	.
Driving head G IV	option	option	option	.	.	.
Grinding arm I	.	.	.	.	.	option
Grinding arm II	.	.	.	.	.	.
Grinding arm III	option	.	.	.	.	.
Grinding arm IV	option	option	.	.	.	.
Grinding arm VI	option	option	option	.	.	.
Adding plates $\varnothing$ 50mm/2" for wider seats	.	.	.	.	.	.
Adding plates $\varnothing$ 70mm/2,8" for wider seats	option	option	option	.	.	.
Adding plates $\varnothing$ 105mm/4,2" for wider seats	option	option	option	option	.	.
Transport and storage case with necessary tools to operate the G	.	.	.	.	.	.
Rough, medium and fine grinding discs 100 of each size applicable to your choice	.	.	.	.	.	.

### Possible range for model G

- A= 140-1361mm (6"-54,4")
- B= 68mm (2,72") min
- C= 100mm (4") min  
900mm (36") standard  
1500mm (60") max (option)
- D= 150 - 1371mm (6" . 54,8")
- L= 730mm (29,2") min

Carrying case Model G 600:  
960x520x380mm /  
15.2"x20.8"x38.4"

Total weight Model G 600:  
67 kg (148 lb)

