

LARSLAP MODEL S

A small, portable machine with the unique LarsLap mounting system.

Ideal for gate and parallel slide valves, discs and wedges.

- Suitable for valves with flat seats \varnothing 25–100 mm (1"–4")
- 3° angle grinding plates as standard
- Air drive unit standard 6–7 bar
- Electric drive unit available
- Variable grinding speed on all drive units
- Supplied with a mounting plate for grinding discs and wedges
- Only three sizes of abrasive discs required for full seat size range
- Self-adhesive grinding discs for quick attachment to the grinding heads
- Supplied with rough, medium and fine grinding discs
- Heavy duty carrying/storage case for the complete machine with all the necessary accessories
- Self-adhesive grinding discs 40 to 1000 grit available
- Diamond grinding discs available

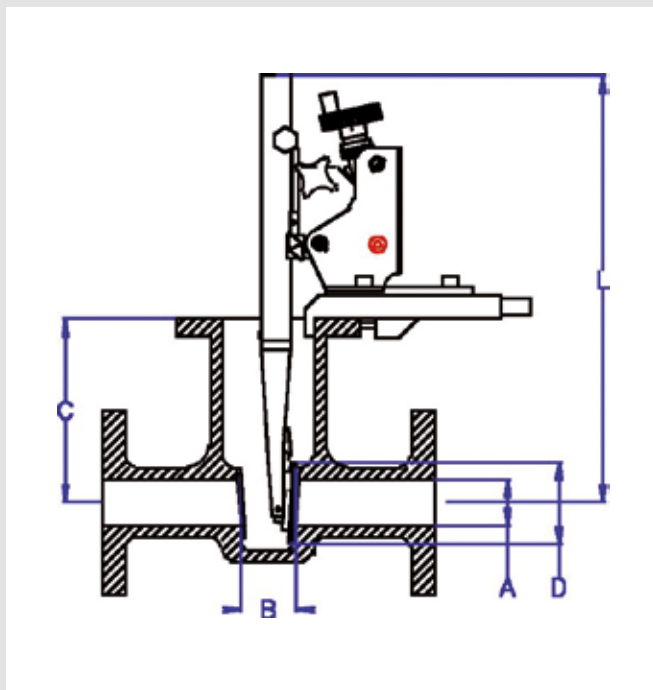

Model S

A:	25–100 mm (1"–4")
B:	19 mm (0,74") min
C:	40 mm (1,6") min 350 mm (13,8") max
D:	35–120 mm (1,38"–4,72")
L:	320 mm (12,6") min 440 mm (17,3") max
Carrying case:	600 x 470 x 230 mm (23,6" x 18,5" x 9")
Total weight:	15 kg (33,75 lb)